

LEGEND:



PROPOSED TREE PLANTING
(INDICATIVE ONLY)



PROPOSED SHRUB PLANTING
(INDICATIVE ONLY)



PROPOSED GRASS AREA

NOTE:
- REFER TO LANDSCAPE AND VISUAL MITIGATION MEASURE OM3, OM5 AND OM6 IN FIGURE 11-5-11.

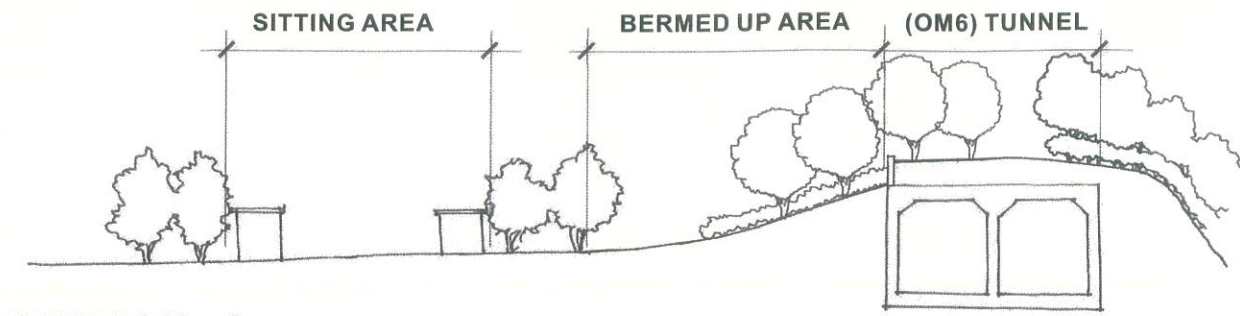

SECTION - A

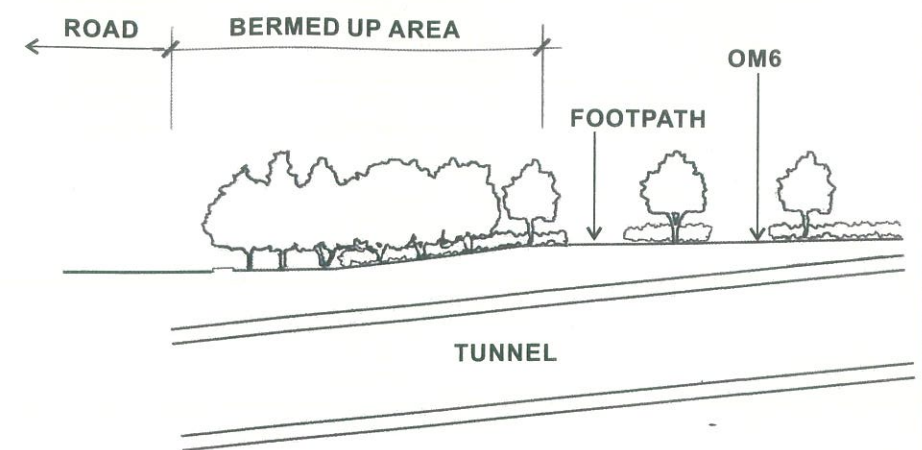

SECTION - B

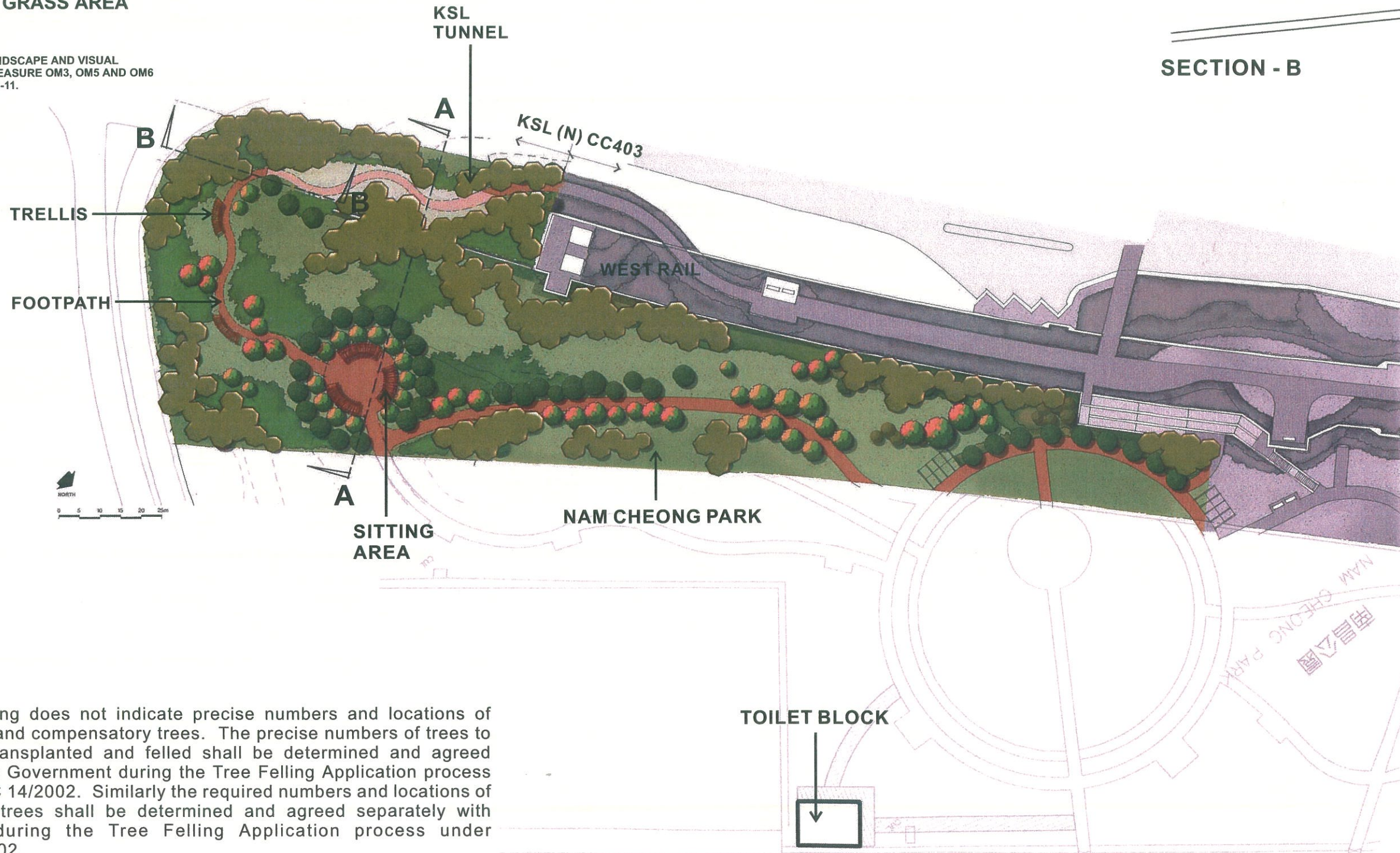

NOTE:
1. This drawing does not indicate precise numbers and locations of retained trees and compensatory trees. The precise numbers of trees to be retained, transplanted and felled shall be determined and agreed separately with Government during the Tree Felling Application process under ETWBTC 14/2002. Similarly the required numbers and locations of compensatory trees shall be determined and agreed separately with Government during the Tree Felling Application process under ETWBTC14/2002.

REV	DATE	BY	SUB	APP	DESCRIPTION

DESIGNED BY
P. SNAITH
DRAWN BY
AAZ
CHECKED BY
A. DUGGIE
IN CHARGE
A. DUGGIE
DATE
JUNE 2004



New Railway Projects
新鐵路策劃

Ove Arup & Partners Hong Kong Limited



KOWLOON SOUTHERN LINK KSL GSA-5100
EIA & ASSOCIATED SERVICES
LANDSCAPE AND VISUAL MITIGATION MEASURES IN THE OPERATION PHASE

CADD FILENAME	CADD DATE
SCALE	AS SHOWN
DRAWING NUMBER	Figure 11-5-22
SHEET NO	STAGE CODE REV
	C

LEGEND:



EXISTING TREES TO BE RETAINED
(INDICATIVE ONLY. EXACT NUMBERS AND LOCATIONS TO BE DETAILED WITHIN THE TREE FELLING APPLICATION)



PROPOSED TREE PLANTING
(INDICATIVE ONLY)



WORKS BOUNDARY

NOTE:

1. This drawing does not indicate precise numbers and locations of retained trees and compensatory trees. The precise numbers of trees to be retained, transplanted and felled shall be determined and agreed separately with Government during the Tree Felling Application process under ETWBTC 14/2002. Similarly the required numbers and locations of compensatory trees shall be determined and agreed separately with Government during the Tree Felling Application process under ETWBTC14/2002.
2. For Key to mitigation measures, refer to Figure 11-5-11.

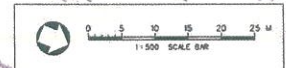

REV	DATE	BY	SUB	APP	DESCRIPTION

DESIGNED BY
P. SNAITH
DRAWN BY
AAZ
CHECKED BY
A. DUGGIE
IN CHARGE
A. DUGGIE
DATE
JUNE 2004

 **New Railway Projects**
新鐵路策劃

Ove Arup & Partners Hong Kong Limited **ARUP**

KOWLOON SOUTHERN LINK KSL GSA-5100
EIA & ASSOCIATED SERVICES
LANDSCAPE AND VISUAL
MITIGATION MEASURES IN THE
OPERATION PHASE

CADD FILENAME	CADD DATE
SCALE	AS SHOWN
DRAWING NUMBER	Figure 11-5-23
SHEET NO	STAGE CODE REV
	C

